



**Fleetwind Drive**  
East Hunsbury, Northampton

**oriordanbond**  
SALES & LETTINGS



## Fleetwind Drive

East Hunsbury

NN4 0SU

PRICE £215,000

Offered to the market with no onward chain is this two bedroom semi-detached home, situated in a quiet cul-de-sac, within the popular area of East Hunsbury.

The accommodation comprises entrance hall, a door leading to a spacious sitting room with stairs to the first floor and a door to a kitchen/dining room. To the first floor is access to the loft space, doors to two bedrooms and a modern bathroom with a shower over the bath. Outside, the property has a lawned front garden with pathway to the house and a driveway to the side providing off road parking. The rear garden is private and westerly facing, has a paved patio seating area, lawn, timber shed and timber fencing to enclose. Further benefits include uPVC double glazing and gas radiator heating. (C/577/M)

### Additional information

- Council Tax Band: B
- Energy Efficiency Rating: C

### Viewing

Viewing strictly by appointment – details below

### Disclaimer

O'Riordan Bond Estate Agents Limited has not tested apparatus, equipment, fittings or services and so cannot verify they are in working order. The buyer is advised to obtain verification from their solicitor or surveyor.

O'Riordan Bond Hunsbury Sales

01604 706007

hunsbury@oriordanbond.co.uk



GROUND FLOOR  
288 sq.ft. (26.8 sq.m.) approx.

1ST FLOOR  
288 sq.ft. (26.8 sq.m.) approx.

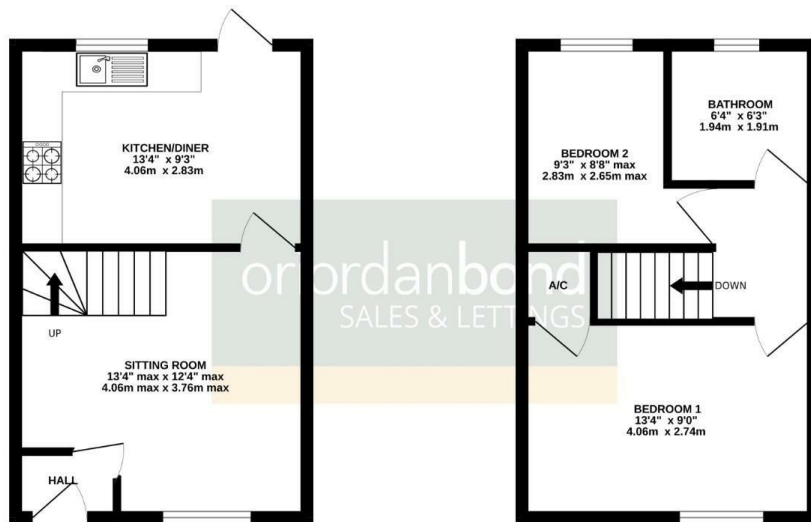

TOTAL FLOOR AREA: 577 sq.ft. (53.6 sq.m.) approx.

Whilst every attempt has been made to ensure the accuracy of the floorplan contained here, measurements of doors, windows, rooms and any other items are approximate and no responsibility is taken for any error, omission or mis-statement. This plan is for illustrative purposes only and should be used as such by any prospective purchaser. The services, systems and appliances shown have not been tested and no guarantee as to their operability or efficiency can be given.  
Made with Metropix ©2025